

## SPECIFICATIONS

**RATING:** 30mA / 28VDC

**OPERATING SPEED:** 10mm/sec

**ELECTRIC LIFE:** 20,000 cycles

**FULL TRAVELS:** 2.0mm

**OPERATING TEMPERATURE:** -40°C to 95°C

## MATERIALS

**PUSHER:** POM Black

**DUST PROTECTION CAP:** POM Black

**CASE:** PA Nature glass fiber reinforced

**SPRING:** Piano wire

**CONTACT/TERMINALS:** Brass, silver plated



## POLE OPTIONS

### SPST

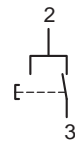
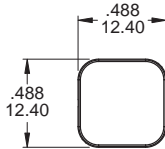

CIRCUIT

### NOTE

Force: 3.4~6.4N

Operating position:  $8.9 \pm 0.2\text{mm}$

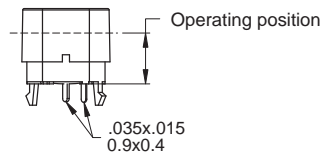
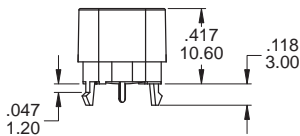

Part No. Shown : PS3001

### P.C. MOUNTING

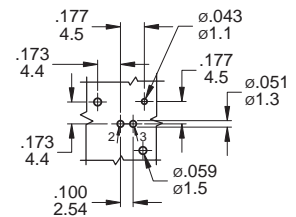

### SPDT

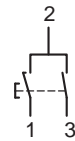
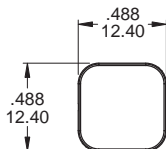

CIRCUIT

### NOTE

Force 1: 5~7N

Force 2: 10~13N

Operating position 1: 9.7

Operating position 2: 8.9

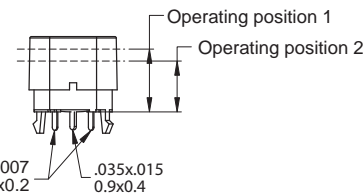
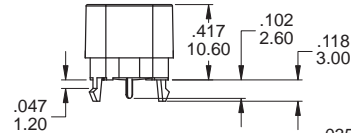

Part No. Shown : PS3002-H

### P.C. MOUNTING

